

# Town of Chatham Town Office Annex & Police Facility



TOWN OFFICE ANNEX AND  
POLICE FACILITY FOR THE  
**TOWN OF CHATHAM**  
GEORGE RYDER ROAD CHATHAM, MASSACHUSETTS

**JJH**  
JACUNSKI THOMPSON  
ARCHITECTS, LLC

JENNIFER H. JACUNSKI  
121 FENN ROAD  
HARTFORD, CT 06111  
TEL: 860-487-9114  
TEL: 860-487-9223

**MAIN  
ENTRANCE  
ELEVATION**

PROJ. NO.	21-0077	DRAWING NO.	
SCALE			<b>A-4</b>
DATE	JANUARY 26, 2007		



TOWN OFFICE ANNEX AND  
POLICE FACILITY FOR THE  
**TOWN OF CHATHAM**  
GEORGE RYDER ROAD CHATHAM, MASSACHUSETTS

**JJH**  
JACUNSKI THOMPSON  
ARCHITECTS, LLC

JENNIFER H. JACUNSKI  
121 FENN ROAD  
HARTFORD, CT 06111  
TEL: 860-487-9114  
TEL: 860-487-9223

**GEORGE  
RYDER ROAD  
ELEVATION**

PROJ. NO.	21-0077	DRAWING NO.	
SCALE			<b>A-3</b>
DATE	JANUARY 26, 2007		

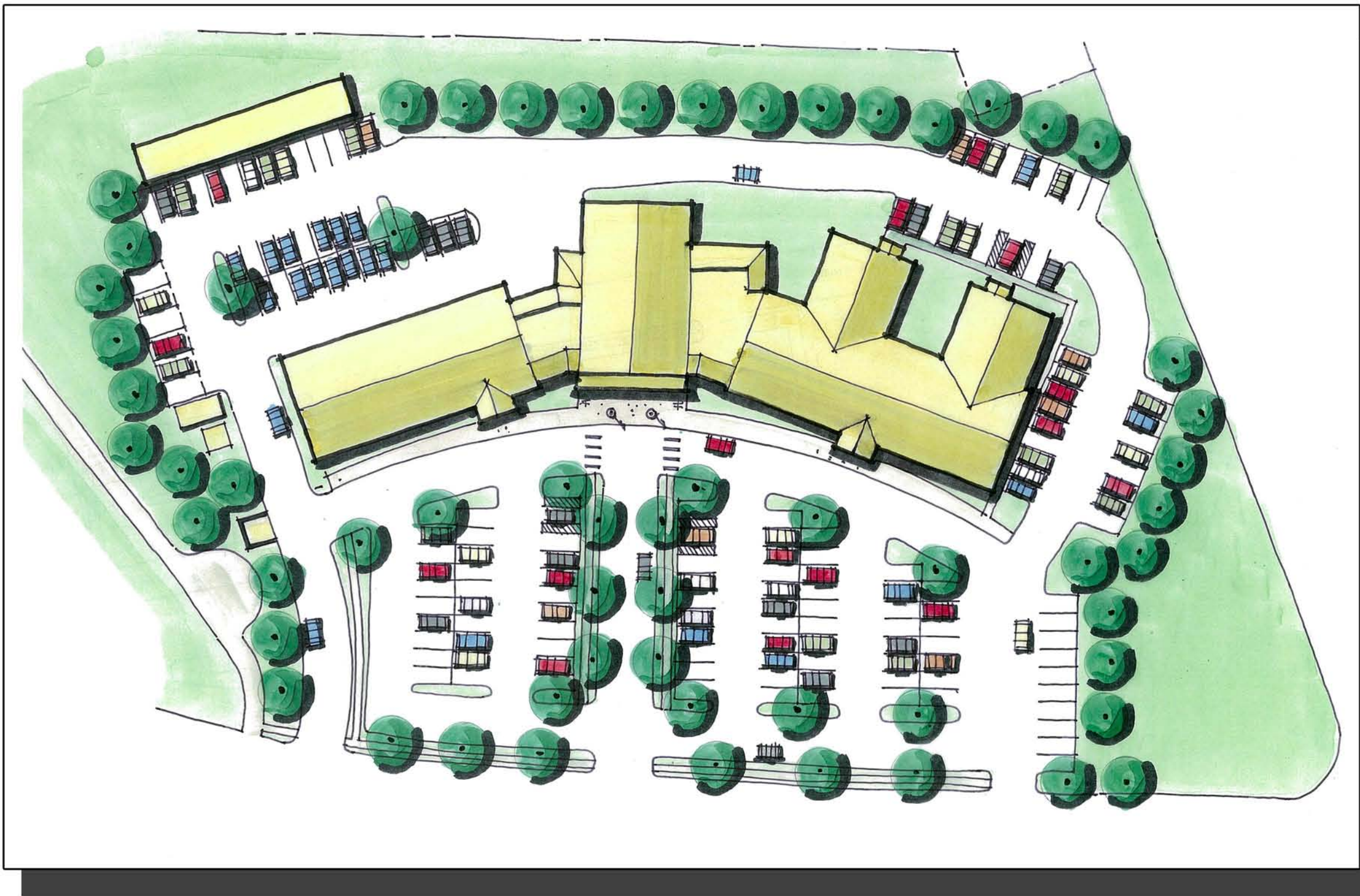

TOWN OFFICE ANNEX AND  
POLICE FACILITY FOR THE  
**TOWN OF CHATHAM**  
GEORGE RYDER ROAD CHATHAM, MASSACHUSETTS

**JJH**  
JACUNSKI THOMPSON  
ARCHITECTS, LLC

JENNIFER H. JACUNSKI  
121 FENN ROAD  
HARTFORD, CT 06111  
TEL: 860-487-9114  
TEL: 860-487-9223

**GEORGE  
RYDER ROAD  
ELEVATION**

PROJ. NO.	21-0077	DRAWING NO.	
SCALE			<b>A-3</b>
DATE	JANUARY 26, 2007		